



PUTTERILLS

est. 1992



£1,450 Per Month
Turpins Rise
Stevenage, SG2 8QZ

PROPERTY SUMMARY

Are you looking for a spacious three-bedroom end-of-Terrance property presented in excellent order throughout? On the ground floor, the accommodation comprises an entrance hall, a generous living/dining area and a kitchen with appliances. On the first floor are two large double bedrooms with built-in cupboard and a good-sized single bedroom. There is also a modern family shower room. This property further benefits from an attractive garden, driveway and parking. Offered unfurnished. A great location is very convenient for the town centre and Stevenage railway station..

3



1



1





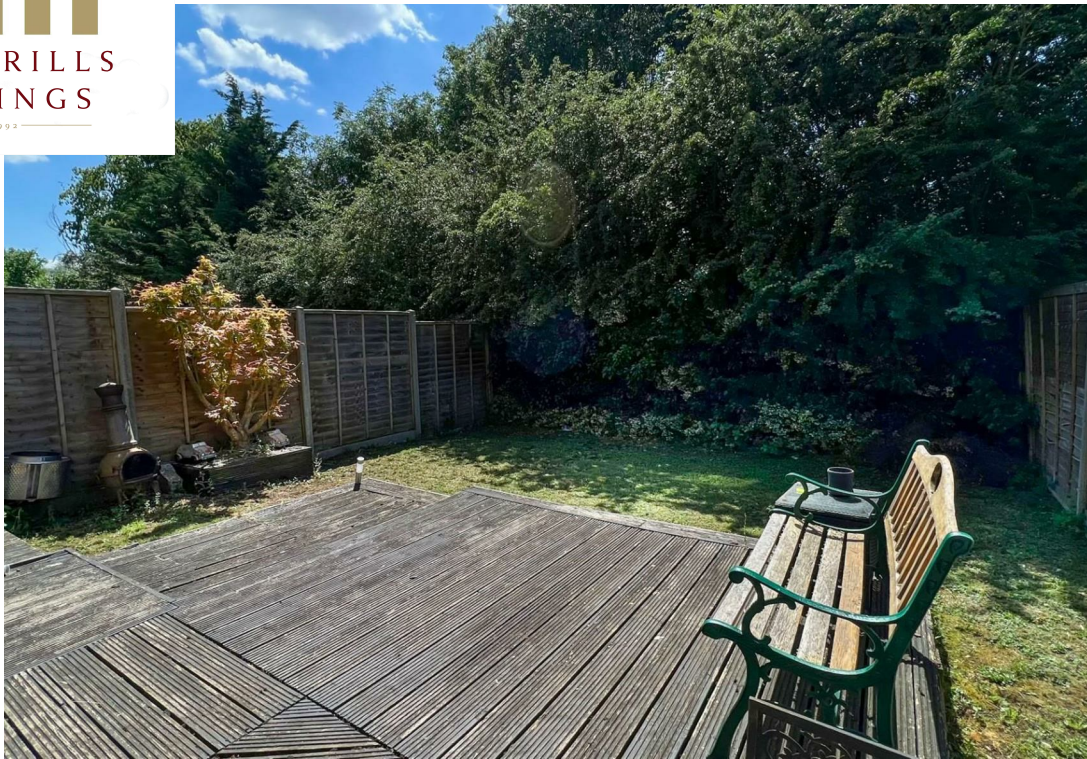
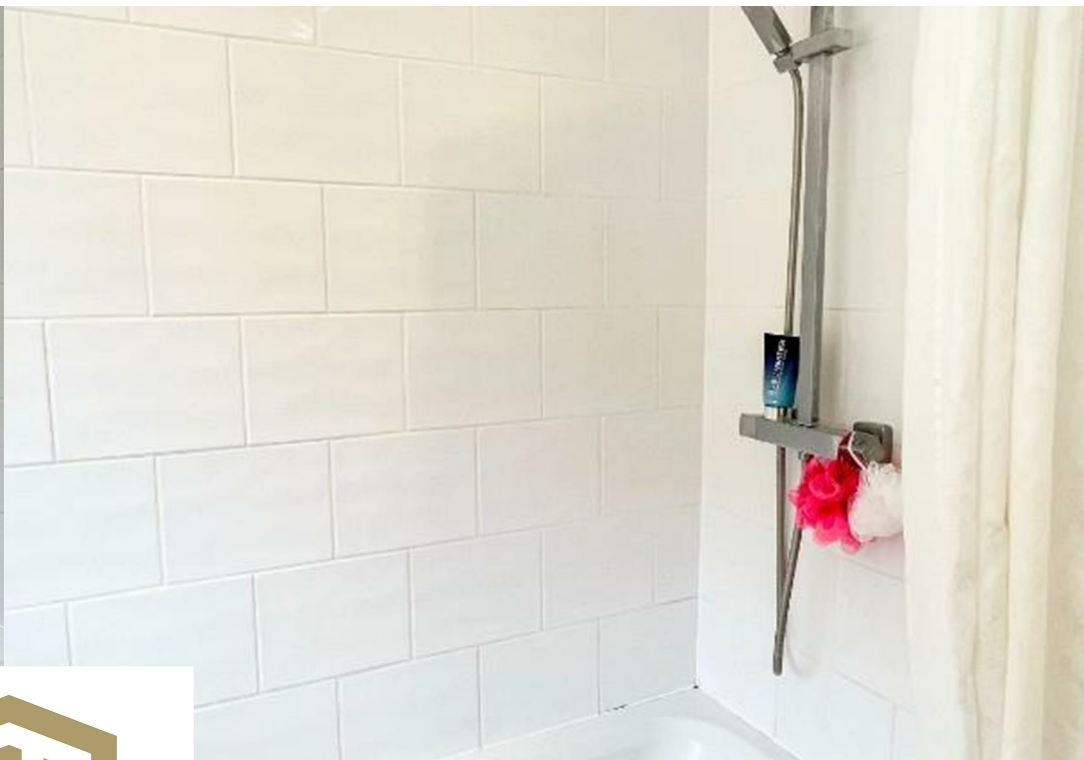



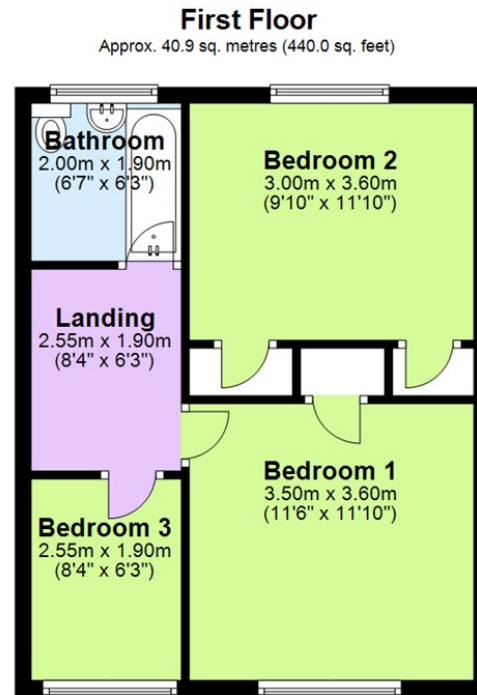
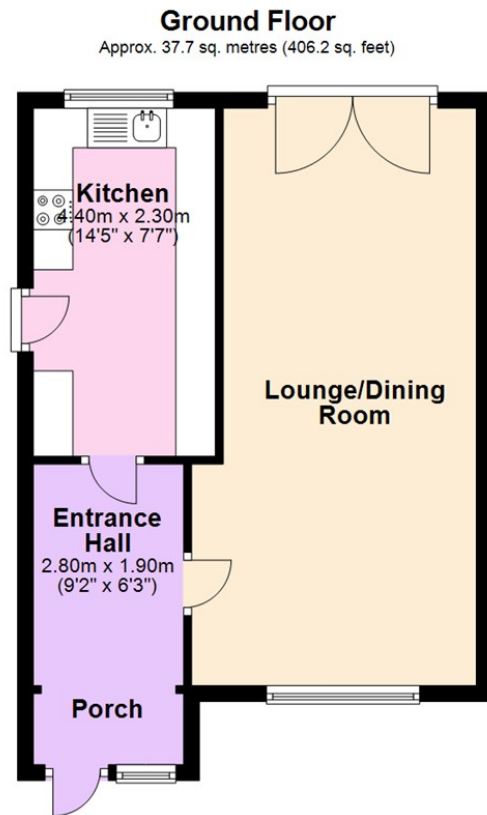

Total area: approx. 78.6 sq. metres (846.3 sq. feet)

Approximate measurements not to scale for room identification purposes only
Plan produced using PlanUp.

LOCAL AUTHORITY

Stevenage

TENURE

COUNCIL TAX BAND

C

VIEWINGS

By prior appointment only

Energy Efficiency Rating		
	Current	Potential
Very energy efficient - lower running costs		
(92 plus) A		
(81-91) B	79	79
(69-80) C		
(55-68) D		
(39-54) E		
(21-38) F		
(1-20) G		
Not energy efficient - higher running costs		
England & Wales		EU Directive 2002/91/EC

Agents Note: Whilst every care has been taken to prepare these particulars, they are for guidance purposes only. All measurements are approximate and are for general guidance purposes only and whilst every care has been taken to ensure their accuracy, they should not be relied upon and potential buyers/tenants are advised to recheck the measurements



OFFICE ADDRESS

Putterills Lettings
123 London Road
Knebworth
SG3 6EX

OFFICE DETAILS

01462 419333
lettings@putterills.co.uk
www.putterills.co.uk